

Perfect PEAK[®]

HPLC/UHPLC STATIC MIXERS

mott
MISSION CRITICAL PRECISION

PerfectPeak[®] Static Mixers offer **UP TO 80% BASELINE NOISE REDUCTION**, **IMPROVED DETECTION LIMITS**, and are **EASILY INSTALLED** into any system

DESCRIPTION

Available in 25, 50, 100, and 150 μ L versions.

PerfectPeak[®] HPLC Static Mixers utilize unique mixing pathways and provide key benefits such as:

- Significant baseline noise reduction
- Less dwell volume than comparable mixers
- Compatibility with a wide range of flow rates
- Quick installation into any HPLC system



BASELINE NOISE

Perfect PEAK[®]

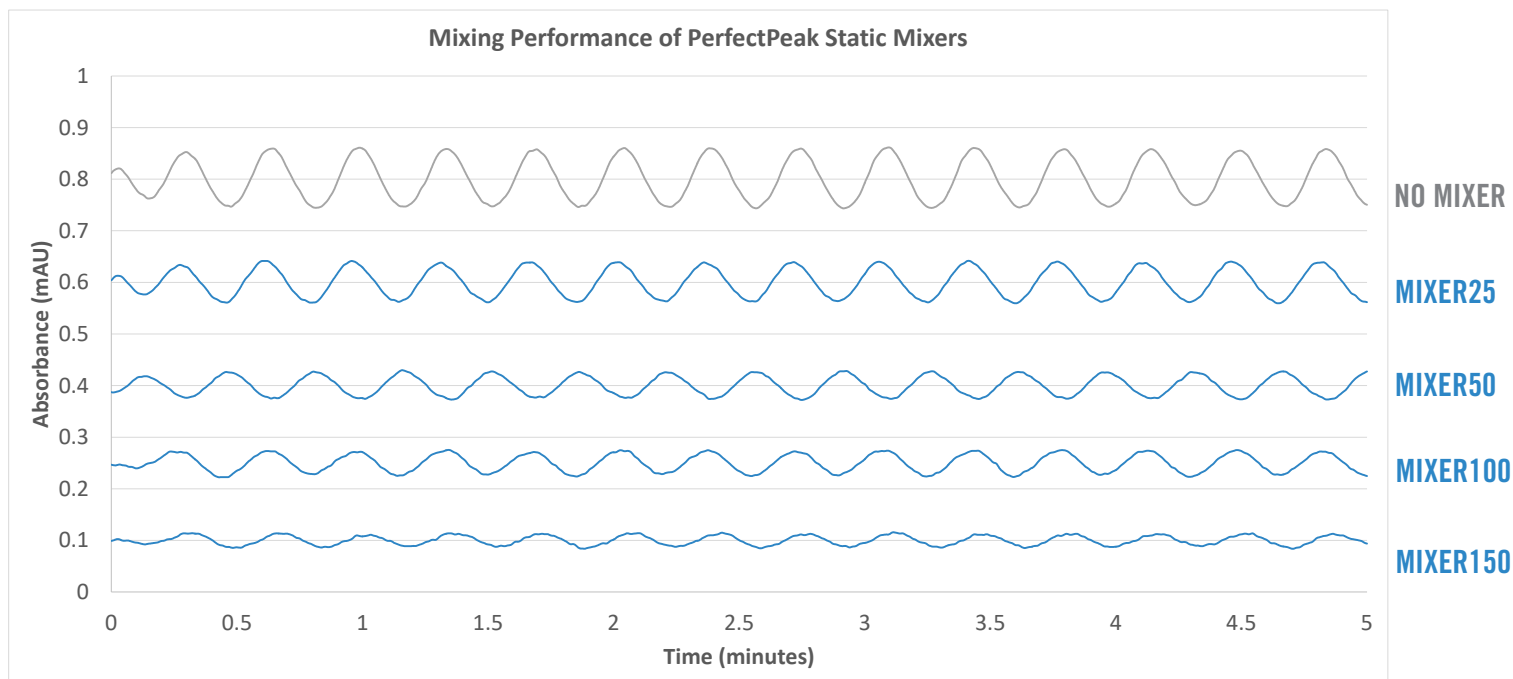

PRODUCT SPECIFICATIONS

	MIXER25	MIXER50	MIXER100	MIXER150
Internal Volume	25 µL	50 µL	100 µL	150 µL
Material of Construction	Passivated 316(L) SS			
Pressure Rating	20,000 PSIG			
Connection Type	Female Compression			
Connection Size	1/16" Tube			
*Custom connections are available upon request				

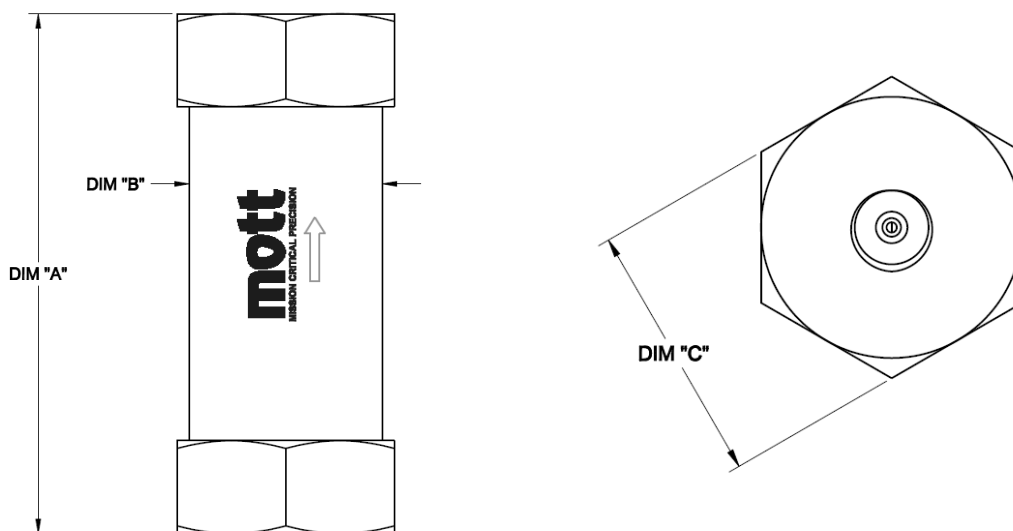

ORDERING INFORMATION

Mixer Volume	"A" Inches/mm	"B" Inches/mm	"C" Inches/mm	Part Number
MIXER25	1.35 / 34.29	0.50 / 12.70	0.56 / 14.22	1850011-01-3D
MIXER50	1.70 / 43.18	0.50 / 12.70	0.56 / 14.22	1850012-01-3D
MIXER100	2.40 / 60.96	0.50 / 12.70	0.56 / 14.22	1850014-01-3D
MIXER150	2.75 / 69.85	0.50 / 12.70	0.56 / 14.22	1850015-01-3D

HPLC Conditions for Mixer Testing Performance

Solvent A: 20 mM Solution of Ammonium Acetate in DI H₂O

Mix Ratio: 20% A / 80% B

Detector: Agilent G1314F VWD

Injector: No Injection

HPLC Column: Column and Injector Bypassed - Pressure Regulator Employed

Solvent B: 80% Acetonitrile (ACN) / 20% DI H₂O

Flow Rate: 0.5 mL/min

Instrument: Agilent 1260 Binary Pump

Wavelength: 220 nm

Perfect PEAK[®]