

# GASSHIELD® POINT-OF-USE SERIES

## POU-30-S

# STAINLESS STEEL FILTER MEDIA



## DESCRIPTION

For maximum gas filtration efficiency, strength and reliability, GasShield POU all-metal gas filters are ideal for Ultra High Purity (UHP) gas delivery applications. They are compatible with most high purity electronics grade process gases. For more point-of-use filter offerings, check out the Mott line of Penta® nickel media or Defender fiber metal filters.

## APPLICATIONS

High Flow UHP gas sticks for Semiconductor, LED, Photovoltaic and MEMS Equipment Hookup. UHP filtration in valve manifold boxes, gas cabinets, tool isolation gas boxes, on-board gas delivery boxes or any process requiring ultra high purity particle removal. Utility gas lines for process and general UHP gas applications.



## OPERATING CONDITIONS

- » Maximum Operating Pressure: 2500 psig (172.5 barg)
- » Maximum Operating Temperature for Inert Gas: 450°C
- » Maximum Differential Pressure: 1000 psid (68.9 bar)

## MATERIALS

- » Hardware: 316L SS
- » Filter Medium: 316L SS
- » Wetted Hardware Surface Finish: 5 Ra, Electro-polished

## SPECIFICATIONS

Particle Removal Size:	≥ 0.0025 μm
Filter Efficiency (Log Reduction Value):	9 LRV (99.9999999% reduction in particles). Confirmed at the most penetrating particle size of 0.08 μm per SEMI F38-0699 test method
Helium Leak Rating:	1 x 10 <sup>-9</sup> atm cc/sec
Moisture Contribution:	<10 ppb after 1 hour at low-flow ambient purge per SEMI F27 test method
Total Hydrocarbons:	Below detectable limits per SEMASPEC 90120396B test method
Particle Shedding:	Zero particle contribution above background (<1 particle/ft <sup>3</sup> ) per SEMIF43-0308 test method

# FLOW DATA

**Mott POU-30-S Flow Rate vs. Differential Pressure**  
 Typical Flow Curves as a Function of System Pressures

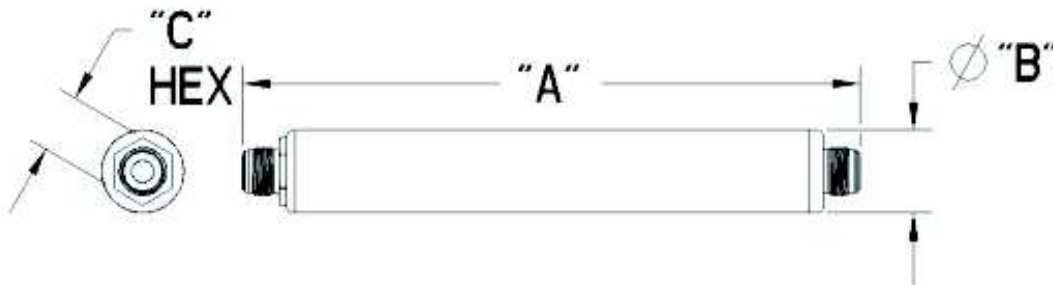
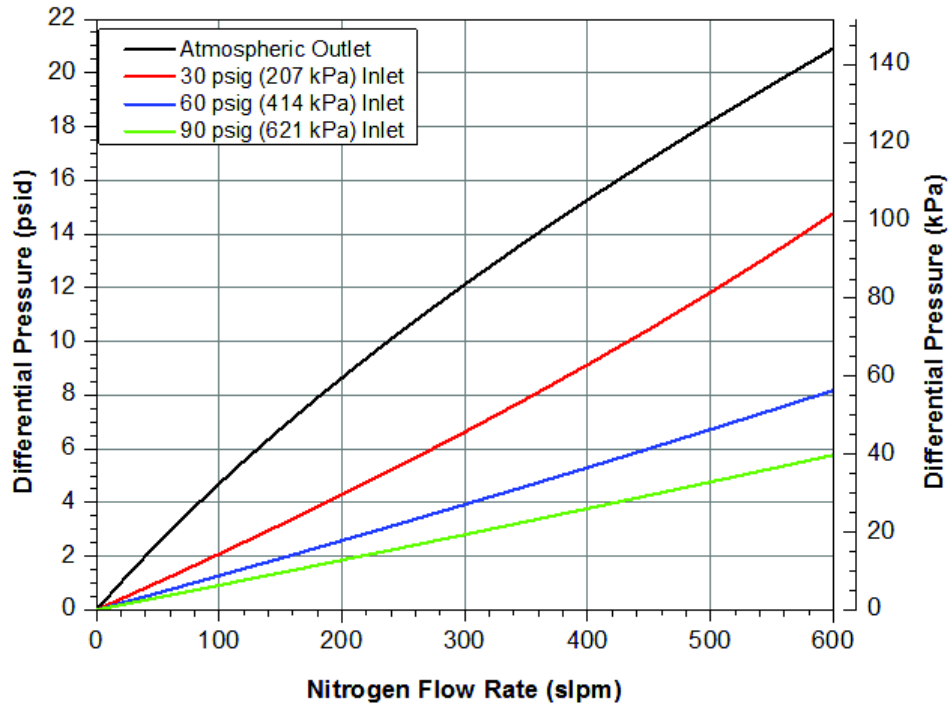

## ORDERING INFORMATION

Part Description	Part Number	Fitting Type	A Inches/mm	B Inches/mm	C Inches/mm
POU-30-SV3	6800074	1/2 inch Male/Male Face Seal	11.22/285.0	1.50/38.1	1.062/26.9
POU-30-ST3	6800140	1/2 inch Butt Weld Tube Stubs	11.22/285.0	1.50/38.1	N/A

\*Custom designs and fittings available. Contact a Mott representative for more information.