

# GASSHIELD® POINT-OF-USE SERIES POU-10-HS HASTELLOY® C-22 FILTER MEDIA & 316L SS HOUSING



## DESCRIPTION

For maximum gas filtration efficiency, strength and reliability, GasShield POU all-metal gas filters are ideal for Ultra High Purity (UHP) gas delivery applications. They are compatible with most high purity electronics grade process gases. For more point-of-use filters, check out the Mott line of Penta® nickel media or Defender fiber metal filters.



## APPLICATIONS

UHP corrosive gas filtration for: gas sticks for equipment hookup, valve manifold boxes, gas cabinets, tool isolation gas boxes, on-board OEM tool gas boxes.

## OPERATING CONDITIONS

- » Maximum Operating Pressure: 2500 psig (172.5 barg)
- » Maximum Operating Temperature for Inert Gas: 450°C
- » Maximum Differential Pressure: 1000 psid (68.9 bar)

## MATERIALS

- » Hardware: 316L SS
- » Filter Medium: Hastelloy C-22
- » Wetted Hardware Surface Finish: 5 Ra, Electro-polished

## SPECIFICATIONS

|   |   |
|---|---|
| Particle Removal Size:                      | ≥ 0.0025 μm   |
| Filter Efficiency<br>(Log Reduction Value): | 9 LRV (99.9999999% reduction in particles).<br>Confirmed at the most penetrating particle size of 0.08 μm per SEMI F38-0699 test method |
| Helium Leak Rating:                         | 1 x 10 <sup>-9</sup> atm cc/sec   |
| Moisture Contribution:                      | <10 ppb after 1 hour at low-flow ambient purge per SEMI F27 test method   |
| Total Hydrocarbons:                         | Below detectable limits per SEMASPEC 90120396B test method  |
| Particle Shedding:                          | Zero particle contribution above background (<1 particle/ft <sup>3</sup> ) per SEMIF43-0308 test method                                 |

# FLOW DATA

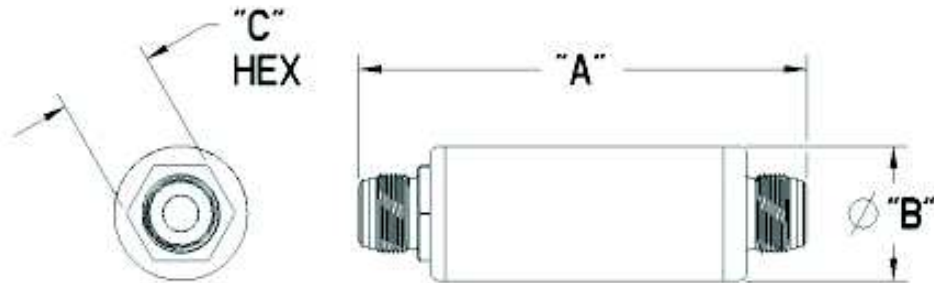
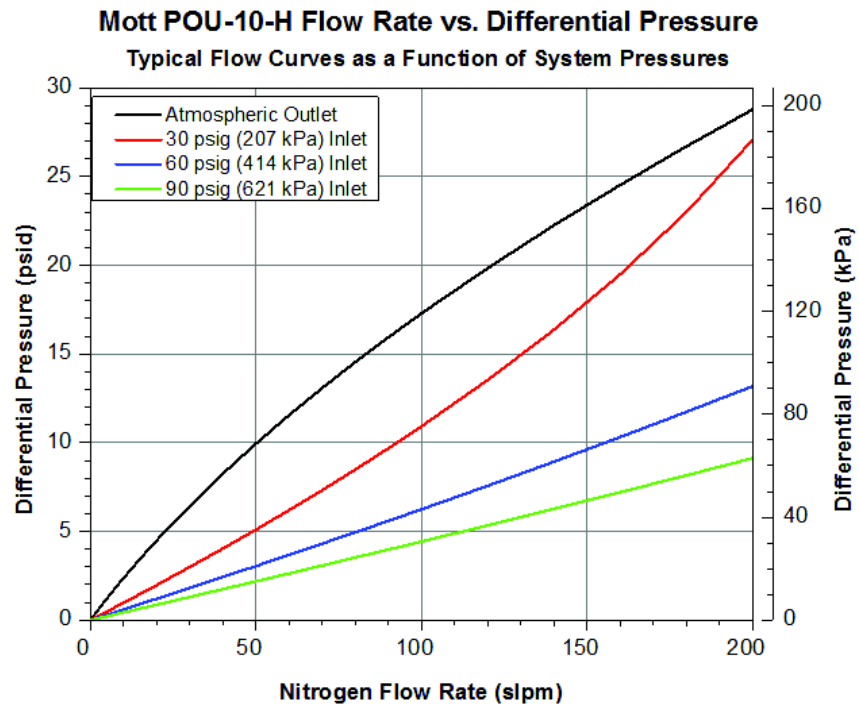

## ORDERING INFORMATION

| Part Description | Part Number | Fitting Type                 | A Inches/mm | B Inches/mm | C Inches/mm |
|------------------|-------------|------------------------------|-------------|-------------|-------------|
| POU-10-HSV1      | 6800046     | 1/4 inch Male/Male Face Seal | 5.00/127.0  | 1.50/38.1   | 1.062/26.9  |
| POU-10-HSV3      | 6800181     | 1/2 inch Male/Male Face Seal | 5.00/127.0  | 1.50/38.1   | 1.062/26.9  |

\*Custom designs and fittings available. Contact a Mott representative for more information.